

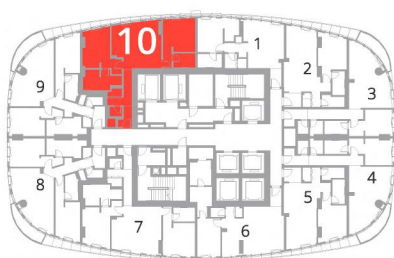

Two Bedroom

Tip/Type - 4



Nivo XXXII Plan
Level XXXII Plan

	DIMENZJE DIMENSIONS
Površina Stana Apartment Area	91.13m ²
Površina Terase Terrace Area	-
Ukupna Površina Total Area	91.13m ²



©2017 BW Kula d.o.o. and ©2017 Marriott International, Inc. All Rights Reserved. The St. Regis logos are the trademarks of Marriott International, Inc., or its affiliates. BW Kula d.o.o. project. The Residences at The St. Regis Belgrade are not owned, developed or sold by Marriott International, Inc., Starwood Eame Licence and Services Company BVBA or their affiliates. BW Kula d.o.o. Beograd uses the St. Regis trademarks and trade names under a license from Starwood Eame Licence and Services Company BVBA. If this license is terminated or expires without renewal, the residential project will no longer be associated with, or have any right to use, the St. Regis trade names or trademarks.

All materials, dimensions and drawings are approximate. Calculation of internal and external area is fully compliant with local standards (SRPS U.C2.100:2002) and as such it represents the net area of the unit.

Svi materijali, dimenzije i crteži su okvirni. Kalkulacija površina unutrašnjeg i spoljašnjeg prostora urađena je u skladu sa važećim standardom (SRPS U.C2.100:2002) i predstavlja neto površinu stambene jedinice.

Tip/Type - 4

